

I. PLANZEICHNUNG M 1:1.000
Bebauungsplan Nr. 23 - Haiming West II
gem. § 13 b BauGB im beschleunigten Verfahren

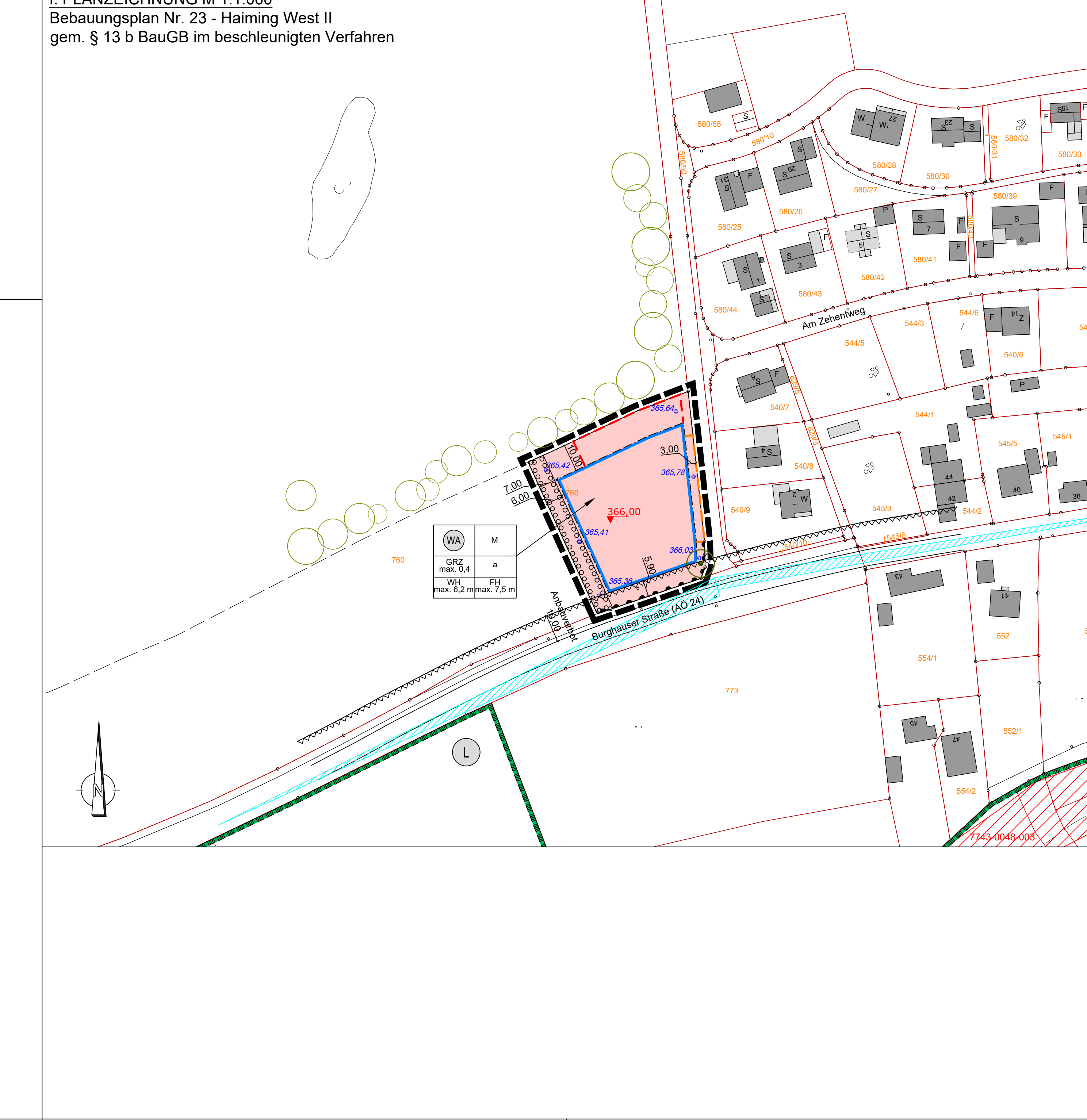

Table containing the Preamble (Präambel), Article 1 (ART DER BAULICHEN NUTZUNG), Article 2 (MASS DER BAULICHEN NUTZUNG), and Article 3 (ART DER BAULICHEN NUTZUNG) with detailed regulations for building types and heights.

Table detailing existing buildings (Bestandsgebäude) and landscape protection areas (Landschaftsschutzgebiet). It lists specific regulations for building types, heights, and landscape preservation measures.

Table detailing building types (Bauweisen) and building lines (Baugrenzen). It specifies rules for building heights, setbacks, and boundary lines.

Table detailing traffic areas (VERKEHRSFLÄCHEN) and other planning zones. It covers regulations for roads, parking, and other public spaces.

Table detailing surface and mass natural protection/landscape care (FLÄCHEN UND MASSHAFTEN NATURSCHUTZ/LANDSCHAFTSPFLEGE). It includes rules for vegetation, soil, and landscape maintenance.

Table detailing parking spaces (STELLPLÄTZE). It specifies the number and location of parking spaces for residential units.

Table detailing earthworks, excavations, and retaining walls (AUFSCÜTTUNGEN, ABGRABUNGEN UND STÜTZMAUERN). It sets rules for soil movement and structural requirements.

Table detailing water management (WASSERWIRTSCHAFT). It covers regulations for water disposal, drainage, and flood protection.

Table detailing noise protection (LÄRMSCHUTZ). It sets standards for noise levels and measures to reduce noise from buildings.

Table detailing text-based regulations for green planning (TEXTLICHE FESTSETZUNGEN ZUR GRÜNORDNUNG). It includes rules for green spaces, trees, and landscaping.

Table detailing text-based regulations for land use planning (TEXTLICHE FESTSETZUNGEN ZUR GRÜNORDNUNG). It covers rules for land use, vegetation, and green infrastructure.

Table detailing text-based regulations for land use planning (TEXTLICHE FESTSETZUNGEN ZUR GRÜNORDNUNG). It includes rules for soil, vegetation, and landscape care.

Table detailing text-based regulations for land use planning (TEXTLICHE FESTSETZUNGEN ZUR GRÜNORDNUNG). It covers rules for building placement, landscaping, and green infrastructure.

Table detailing trees and shrubs (Bäume II. Ordnung). It lists specific tree and shrub species and their management requirements.

Table detailing plant species (UNZULÄSSIGE PFLANZENARTEN). It lists plants that are prohibited in the planning area.

Table detailing meadow areas (WIESENFLÄCHEN). It sets rules for the use and maintenance of meadows.

Table detailing the location of power and telecommunications lines (LAGE VON VER- UND ENTSORGUNGSLEITUNGEN). It regulates the placement of utility lines.

Table detailing plant treatment methods (PFLANZENBEHANDLUNGSMITTEL). It lists approved and prohibited plant treatments.

Table detailing tree species (ARTENSCHUTZ). It lists protected tree species and their management rules.

Table detailing landscape protection (SCHUTZ DES MUTTERBODENS NACH § 202 BauGB). It sets rules for soil protection and land use.

Table detailing soil load (BODENBELASTUNG MIT PERFLUOROALKANSÄURE (PFOA)). It sets limits on soil contamination from PFAS.

Text detailing the handling of soil material, its reuse, and disposal. It includes rules for soil quality and environmental protection.

Text detailing the use of solar energy (SOLARENERGIE). It encourages solar power and sets guidelines for its installation.

Text detailing the location of power and telecommunications lines (LAGE VON VER- UND ENTSORGUNGSLEITUNGEN). It provides additional rules for utility line placement.

Text detailing the location of power and telecommunications lines (LAGE VON VER- UND ENTSORGUNGSLEITUNGEN). It includes more details on utility line regulations.

Text detailing the location of power and telecommunications lines (LAGE VON VER- UND ENTSORGUNGSLEITUNGEN). It covers various aspects of utility line management.

Text detailing the location of power and telecommunications lines (LAGE VON VER- UND ENTSORGUNGSLEITUNGEN). It provides further guidance on utility lines.

Text detailing the location of power and telecommunications lines (LAGE VON VER- UND ENTSORGUNGSLEITUNGEN). It includes rules for underground utilities.

Text detailing the location of power and telecommunications lines (LAGE VON VER- UND ENTSORGUNGSLEITUNGEN). It covers final aspects of utility line regulations.

Text detailing the location of power and telecommunications lines (LAGE VON VER- UND ENTSORGUNGSLEITUNGEN). It includes rules for utility line placement.

Text detailing the location of power and telecommunications lines (LAGE VON VER- UND ENTSORGUNGSLEITUNGEN). It covers utility line management.

Text detailing the location of power and telecommunications lines (LAGE VON VER- UND ENTSORGUNGSLEITUNGEN). It includes more utility line rules.

Text detailing the location of power and telecommunications lines (LAGE VON VER- UND ENTSORGUNGSLEITUNGEN). It provides further utility line guidance.

Text detailing the location of power and telecommunications lines (LAGE VON VER- UND ENTSORGUNGSLEITUNGEN). It covers utility line placement.

Text detailing the location of power and telecommunications lines (LAGE VON VER- UND ENTSORGUNGSLEITUNGEN). It includes utility line management rules.

Text detailing the location of power and telecommunications lines (LAGE VON VER- UND ENTSORGUNGSLEITUNGEN). It covers utility line placement.

Text detailing the location of power and telecommunications lines (LAGE VON VER- UND ENTSORGUNGSLEITUNGEN). It includes final utility line regulations.

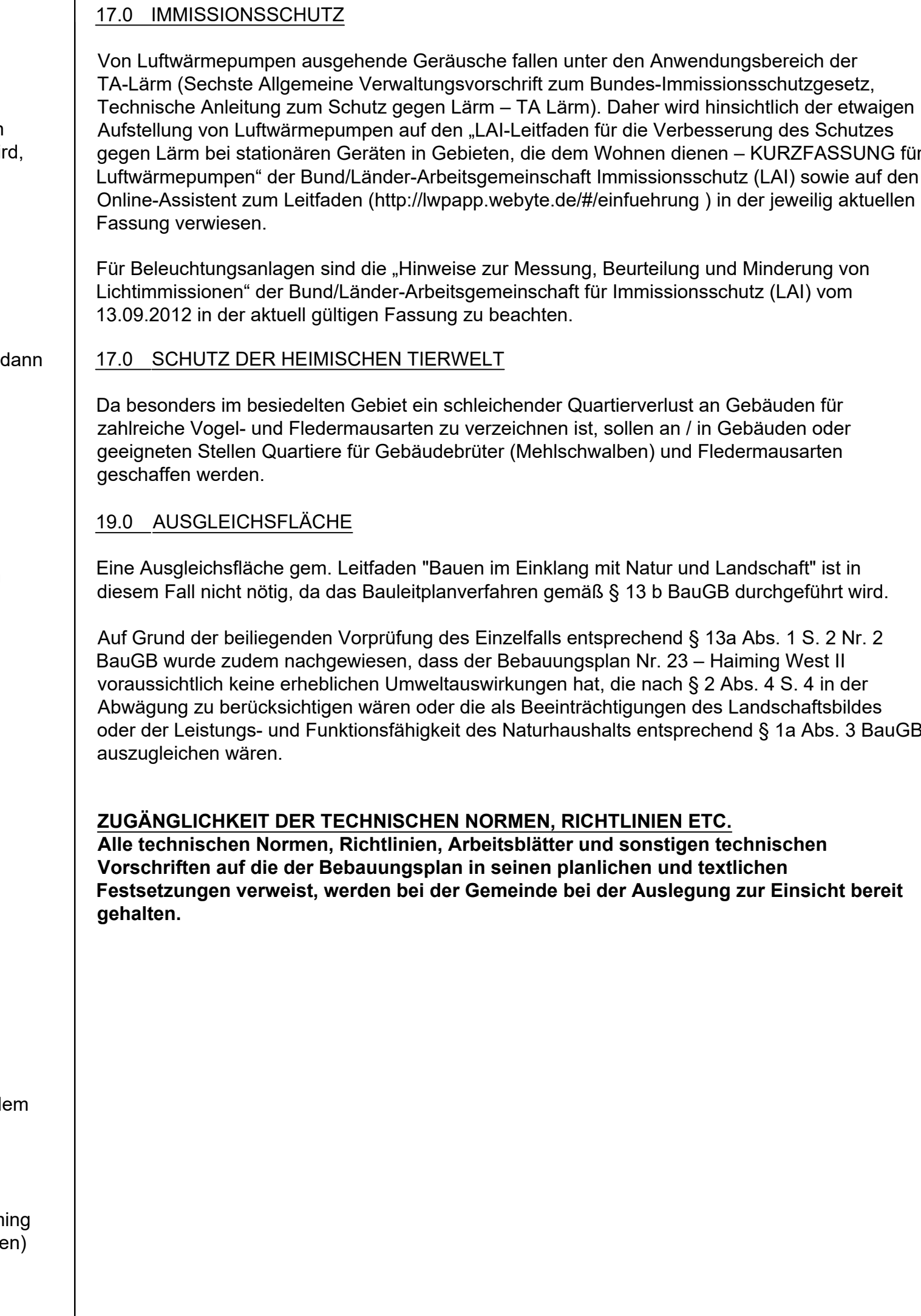

Table detailing the location of power and telecommunications lines (LAGE VON VER- UND ENTSORGUNGSLEITUNGEN). It includes rules for utility line placement.

Table detailing the location of power and telecommunications lines (LAGE VON VER- UND ENTSORGUNGSLEITUNGEN). It covers utility line management.

Table detailing the location of power and telecommunications lines (LAGE VON VER- UND ENTSORGUNGSLEITUNGEN). It includes utility line placement rules.

Table detailing the location of power and telecommunications lines (LAGE VON VER- UND ENTSORGUNGSLEITUNGEN). It covers utility line management.